

DOWNTOWN LANDSCAPE IMPROVEMENTS

FOR THE CITY OF PORT ST. JOE

INDEX OF SHEETS

LS.02	TABULATION OF QUANTITIES
LS.03	GENERAL NOTES
LS.04 THRU LS.09	LANDSCAPE PLANS
LS.10 THRU LS.11	LANDSCAPE DETAILS
IR.01 THRU IR.06	IRRIGATION PLANS
IR.07 THRU IR.09	IRRIGATION DETAILS
IR.10 THRU IR.12	IRRIGATION SPECIFICATIONS



PREPARED FOR:

MATT FLECK, EXECUTIVE DIRECTOR
 PORT ST. JOE REDEVELOPMENT AGENCY
 150 CAPTAIN FRED'S PLACE
 PORT ST. JOE, FLORIDA 32456
 850-229-6899
 MATT@PSJRA.COM

PREPARED BY:



GGI, LLC dba GENESIS GROUP
 2507 CALLAWAY ROAD, SUITE 100
 TALLAHASSEE, FLORIDA 32303
 (850) 224-4400 (850) 681-3600 FAX
 LANDSCAPE ARCHITECTURE LC26000202
 www.GenesisGroup.com

LANDSCAPE ARCHITECT OF RECORD:

JOSEPH C. PETRICH, R.L.A.
 FLA License Number: 1173

DATE: 8/12/2009

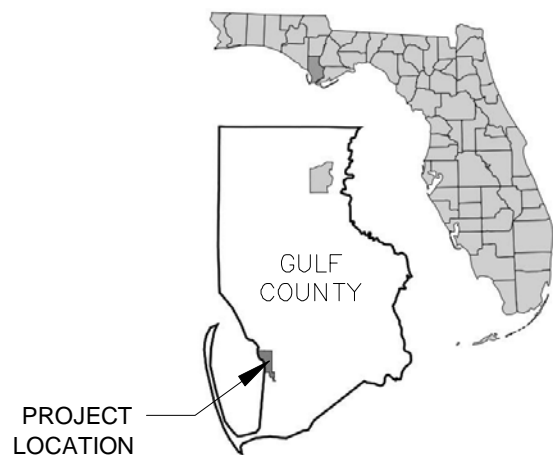

PROJECT
LOCATION

PROJECT
LOCATION

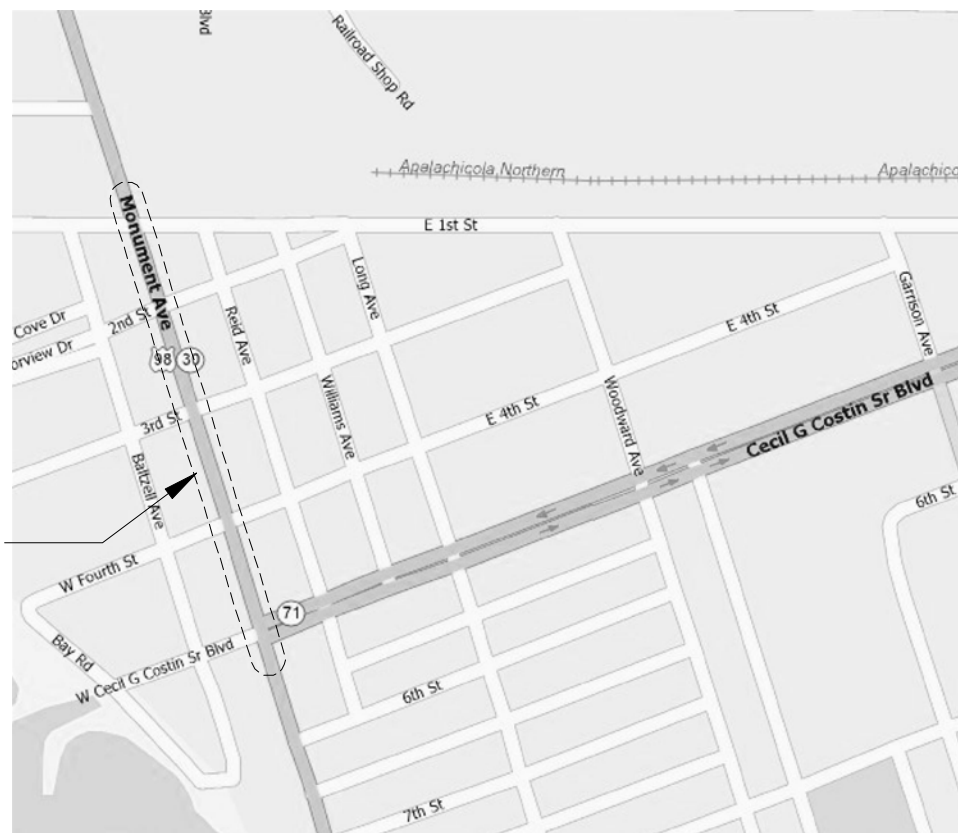

LOCATION MAP

N.T.S.

GULF COUNTY, FLORIDA

INCLUDED IN PLANS BY REFERENCE:

FLORIDA DEPARTMENT OF TRANSPORTATION
 CONSTRUCTION STANDARDS AND DETAILS
<http://www.dot.state.fl.us/rddesign/rd/rtds/08/2008Standards.shtm>

NOTE : PROJECT TO BE CONSTRUCTED AS PER
 FLORIDA DEPARTMENT OF TRANSPORTATION
 STANDARD SPECIFICATIONS FOR ROAD AND
 BRIDGE CONSTRUCTION, 2007 EDITION, UNLESS
 OTHERWISE SHOWN BY DESIGN DETAILS OR
 MODIFIED BY CONTRACT DOCUMENTS.

LANDSCAPE TABULATION OF QUANTITIES

PAY ITEM NO.	SYM	DESCRIPTION	INSTALLED SIZE	MAXIMUM MAINTAINED SIZE	UNIT	SHEET NUMBERS												TOTAL THIS SHEET		GRAND TOTAL		REF. SHEET
						LS.04		LS.05		LS.06		LS.07		LS.08		LS.09		PLAN	FINAL	PLAN	FINAL	
						PLAN	FINAL	PLAN	FINAL	PLAN	FINAL	PLAN	FINAL	PLAN	FINAL	PLAN	FINAL					
LARGE																						
	SP	SABAL PALMETTO/ CABBAGE PALM	16' C.T., STRAIGHT		EA			12		17		11		13		5			58			
SMALL																						
	GP	GAILLARDIA PULCHELLA/ BLANKET FLOWER	OVERSEED - 1lb. PER 5,000 SF	16" HT. x 12" SPR.	SF	682		769		372		571		791		327			3512			
	RC	RUPELLIA CAROLINIENSIS/ WILD PETUNIA	1 QT., FULL PLANT, 16" O.C.	9" HT. x 18" SPR.	EA	120		145		73		107		146		62			653			
	SPL	SESUVIUM PORTULACASTRUM/ SEA PURSLANE	1 QT., FULL PLANT, 16" O.C.	9" HT. x 18" SPR.	EA	120		145		73		108		148		62			656			
	SB	SPARTINA BAKERI/ SAND CORDGRASS	1 GAL., FULL PLANT 30" O.C.	42" HT. x 42" SPR.	EA					38									38			
	SL	STOKESIA LAEVIS/ STOKES' ASTER	1 QT., FULL PLANT, 16" O.C.	16" HT. x 18" SPR.	EA	120		145		68		108		146		61			648			
		IRRIGATION SYSTEM			LS														1			

REVISIONS						JOSEPH C. PETRICH, R.L.A. R.L.A. LICENSE NUMBER 1173 GGI, LLC, dba GENESIS GROUP 9822 TAPESTRY PARK CIRCLE, SUITE 201 JACKSONVILLE, FL 32246 LANDSCAPE ARCHITECTURE LC26000202	STATE OF FLORIDA DEPARTMENT OF TRANSPORTATION			TABULATION OF QUANTITIES	SHEET NO.
DATE	BY	DESCRIPTION	DATE	BY	DESCRIPTION		ROAD NO.	COUNTY	FINANCIAL PROJECT ID		LS.02
							30(U.S.98)	GULF	416533-6-58-05		

GENERAL NOTES

1. THE LANDSCAPE CONTRACTOR SHALL BE A FLORIDA CERTIFIED LANDSCAPE CONTRACTOR AS CERTIFIED BY THE FLORIDA NURSERYMEN AND GROWERS ASSOCIATION. PHONE NUMBER: (407) 295-7994.
2. CONTRACTOR SHALL INSTALL PLANT MATERIAL AS INDICATED ON THE PLANS AND IN ACCORDANCE WITH FDOT STANDARD SPECIFICATION SECTION 580.
3. CONTRACTOR SHALL INSTALL PLANTINGS IN ACCORDANCE WITH FDOT STANDARD INDEX NO. 544 UNLESS OTHERWISE NOTED HEREIN. THE LANDSCAPE CONTRACTOR SHALL NOT BE REQUIRED TO INSTALL TREE BARRICADES AS PROVIDED PER INDEX NO. 544.
4. PLANT STAKING SHALL BE IN ACCORDANCE WITH FDOT INDEX NO. 544.
5. CONTRACTOR SHALL BE RESPONSIBLE FOR WATERING AND MAINTAINING PLANT MATERIAL FOR THE DURATION OF THE ESTABLISHMENT PERIOD.
6. DO NOT MAKE ANY CHANGES, SUBSTITUTIONS, OR REVISIONS TO THE PLANS. ANY CHANGES, SUBSTITUTIONS, OR REVISIONS MUST HAVE PRIOR APPROVAL BY THE PROJECT ENGINEER AND LANDSCAPE ARCHITECT.
7. CONTRACTOR SHALL STAKE LOCATIONS OF ALL TREES FOR REVIEW AND APPROVAL BY THE PROJECT ENGINEER AND LANDSCAPE ARCHITECT. THE PROJECT ENGINEER AND LANDSCAPE ARCHITECT RESERVE THE RIGHT TO MAKE ANY LOCATIONAL CHANGES NECESSARY.
8. IMPORT TOPSOIL FROM OFF-SITE SOURCES, IF REQUIRED. TOP SOIL SHALL BE DEFINED AS THE UPPER 4" TO 6" OF NATURALLY OCCURRING SOILS SUITABLE FOR AGRICULTURAL PRODUCTION, AND ARE WITHOUT DRAINAGE LIMITATIONS. OBTAIN TOPSOIL FROM NATURALLY WELL-DRAINED SITES WHERE TOPSOIL OCCURS AT LEAST 4" DEEP. UNDER NO CIRCUMSTANCES SHOULD TOPSOIL BE OBTAINED FROM BOGS OR MARSHES.
9. PLANTING SOIL BACKFILL MIX: FOR TREE PITS, SHRUB AND GROUND COVER PLANTINGS, MIX 50% EXISTING TOPSOIL TO 50% MUSHROOM COMPOST TO COMPLY WITH FLORIDA STATUTE 335.167 AND SOIL AMENDMENTS AS REQUIRED TO ESTABLISH A pH BETWEEN 5.5 AND 6.0. MUSHROOM COMPOST AVAILABLE THROUGH QUINCY FARMS OF QUINCY, FLORIDA. ALTERNATE PLANTING SOIL BACKFILL MIXTURE: MIX 50% EXISTING TOPSOIL TO 50% SOIL ADMIXTURE COMPRISED OF 1/3 PARTS DECOMPOSED PINE BARK, 1/3 PARTS COMMERCIALY PROCESSED COW MANURE AND 1/3 PARTS CANADIAN PEAT AND AMENDMENTS AS REQUIRED TO ESTABLISH A pH BETWEEN 5.5 AND 6.0.

FOR SOD AREAS: APPLY 2" LAYER OF MUSHROOM COMPOST OR THE ALTERNATIVE PLANTING SOIL BACKFILL MIX AND INCORPORATE TO 6" DEPTH PER FDOT STANDARD SPECIFICATION SECTION 575.

FERTILIZER FOR INITIAL INSTALLATION OF TREES, SHRUBS, GROUNDCOVERS AND FOR GRASSING AND SOD AREAS SHALL BE OSMOCOTE PLUS 15-9-12 SOUTHERN STOCK NO. 90330, SLOW RELEASE FERTILIZER AS MANUFACTURED BY SCOTT'S COMPANY, OR APPROVED EQUAL FORMULATION.

INCORPORATE FERTILIZER INTO PLANTING SOILS / BACKFILL AS FOLLOWS:

.50 OZ. PER EA. 4" POT OR PLANT LINER	9.0 OZ. PER EA. 15 GALLON CONTAINER
1.0 OZ. PER EA. 1 GALLON CONTAINER	14.0 OZ. PER EA. 20 GALLON CONTAINER
2.0 OZ. PER EA. 2 GALLON CONTAINER	17.0 OZ PER EA. 25 GALLON CONTAINER
3.0 OZ. PER EA. 3 GALLON CONTAINER	30 OZ. PER EA. 45 GALLON CONTAINER
5.0 OZ. PER EA. 5 GALLON CONTAINER	44.5 OZ PER EA. 65 GALLON CONTAINER
6.0 OZ. PER EA. 7 GALLON CONTAINER	69.0 OZ. PER EA. 100 GALLON CONTAINER
8.5 OZ. PER EA. 10 GALLON CONTAINER	136 OZ. PER EA. 200 GALLON CONTAINER

FOR GRASSING AND SOD AREAS:
APPLY 40#/1000 SF.

FOR PALMS:
APPLY 40 OZ. PER TREE, INCORPORATED INTO PLANTING BACKFILL MIX.

10. CONTRACTOR SHALL NOTIFY THE PROJECT ENGINEER AND LANDSCAPE ARCHITECT IMMEDIATELY OF ANY UNFORESEEN SITE CONDITIONS (COMPACTED SOIL/SUBGRADE, POOR DRAINAGE, UTILITY CONFLICTS, ETC.) PRIOR TO PRECEEDING WITH LANDSCAPE INSTALLATION.
11. ALL GRADABLE NURSERY PLANTS SHALL BE FLORIDA NO. 1 GRADE OR BETTER AS DESCRIBED IN "GRADES AND STANDARDS FOR NURSERY PLANTS", STATE OF FLORIDA, SECOND EDITION.

12. ALL PLANTS, MATERIAL, LABOR, AND WORKMANSHIP ARE SUBJECT TO APPROVAL BY THE PROJECT ENGINEER AND LANDSCAPE ARCHITECT. ALL PLANTS SHALL BE FREE FROM WEED, INSECT AND DISEASE INFESTATIONS.
13. BACKFILL PLANTING PITS WITH ENOUGH COMPACTED PLANTING MIX SO THAT THE TOP OF THE ROOT BALL WILL REST AT THE FINISHED GRADE.
14. BACKFILL PLANTING PITS WITH APPROVED PLANTING MIX. FORM A SOIL BERM AROUND THE OUTER EDGE OF THE PIT TO FACILITATE WATER UPTAKE.
15. MULCH ALL PLANTING BEDS WITH PINE STRAW TO A MINIMUM COMPACTED DEPTH OF 2".
16. THE CONTRACTOR SHALL WARRANTY ALL PLANT MATERIAL FOR 1 YEAR. ANY PLANT THAT DOES NOT MEET THE GRADES AND STANDARDS FOR FLORIDA NO. 1 SHALL BE PROMPTLY REMOVED AND REPLACED BY THE CONTRACTOR TO THE SATISFACTION OF THE PROJECT ENGINEER AND LANDSCAPE ARCHITECT.
17. WARRANTY INSPECTION SHALL BE CONDUCTED AT 90 DAY INTERVALS DURING THE ESTABLISHMENT PERIOD. THE ESTABLISHMENT PERIOD FOR WATERING AND MAINTENANCE BY THE CONTRACTOR SHALL BE 365 DAYS. THE CONTRACTOR SHALL REQUEST AN ESTABLISHMENT PERIOD INSPECTION AT THE END OF THE 365 DAY ESTABLISHMENT PERIOD. A REPRESENTATIVE FROM THE AGENCY RESPONSIBLE FOR MAINTENANCE SHALL BE IN ATTENDANCE AT THE ESTABLISHMENT PERIOD INSPECTION.
18. AREAS DESIGNATED AS NATURAL AREAS OR EXISTING VEGETATION TO REMAIN SHALL REMAIN UNDISTURBED. DO NOT STORE EQUIPMENT OR MATERIALS IN THESE AREAS.
19. WORK ZONE TRAFFIC CONTROL SHALL BE MAINTAINED IN ACCORDANCE WITH FDOT DESIGN STANDARDS INDEXES 600 AND 602.
20. DOCUMENTATION OF DETAIL DESIGN IS BASED ON PLANS PROVIDED BY FDOT.
21. LOCATE ALL UTILITIES PRIOR TO LANDSCAPE INSTALLATION.

UTILITY NOTES

1. A UTILITY REPRESENTATIVE SHALL BE PRESENT IF LANDSCAPING REQUIRES ANY EXCAVATION GREATER THAN 36".
2. THE CONTRACTOR SHALL COORDINATE WITH THE UTILITY COMPANIES DURING THE CONSTRUCTION. NO UTILITY SHALL BE RELOCATED. PLANTING SHALL BE ADJUSTED HORIZONTALLY, AT THE DIRECTION OF ENGINEER, TO NEGATE ANY UTILITY CONFLICT.
3. UTILITY LOCATIONS ON THE PLANS ARE APPROXIMATE ONLY. THESE HAVE NOT BEEN VERIFIED EITHER HORIZONTALLY OR VERTICALLY.
4. THE CONTRACTOR SHALL NOTIFY UTILITY OWNERS THROUGH SUNSHINE STATE ONE-CALL OF FLORIDA, INC. (1-800-432-4770) TWO BUSINESS DAYS IN ADVANCE OF BEGINNING WORK ON THE JOB SITE.

REVISIONS						JOSEPH C. PETRICH, R.L.A. R.L.A. LICENSE NUMBER 1173 GGI, LLC, dba GENESIS GROUP 9822 TAPESTRY PARK CIRCLE, SUITE 201 JACKSONVILLE, FL 32246 LANDSCAPE ARCHITECTURE LC26000202	STATE OF FLORIDA DEPARTMENT OF TRANSPORTATION			GENERAL NOTES	SHEET NO.
DATE	BY	DESCRIPTION	DATE	BY	DESCRIPTION		ROAD NO.	COUNTY	FINANCIAL PROJECT ID		
							30(U.S.98)	GULF	416533-6-58-05		LS.03

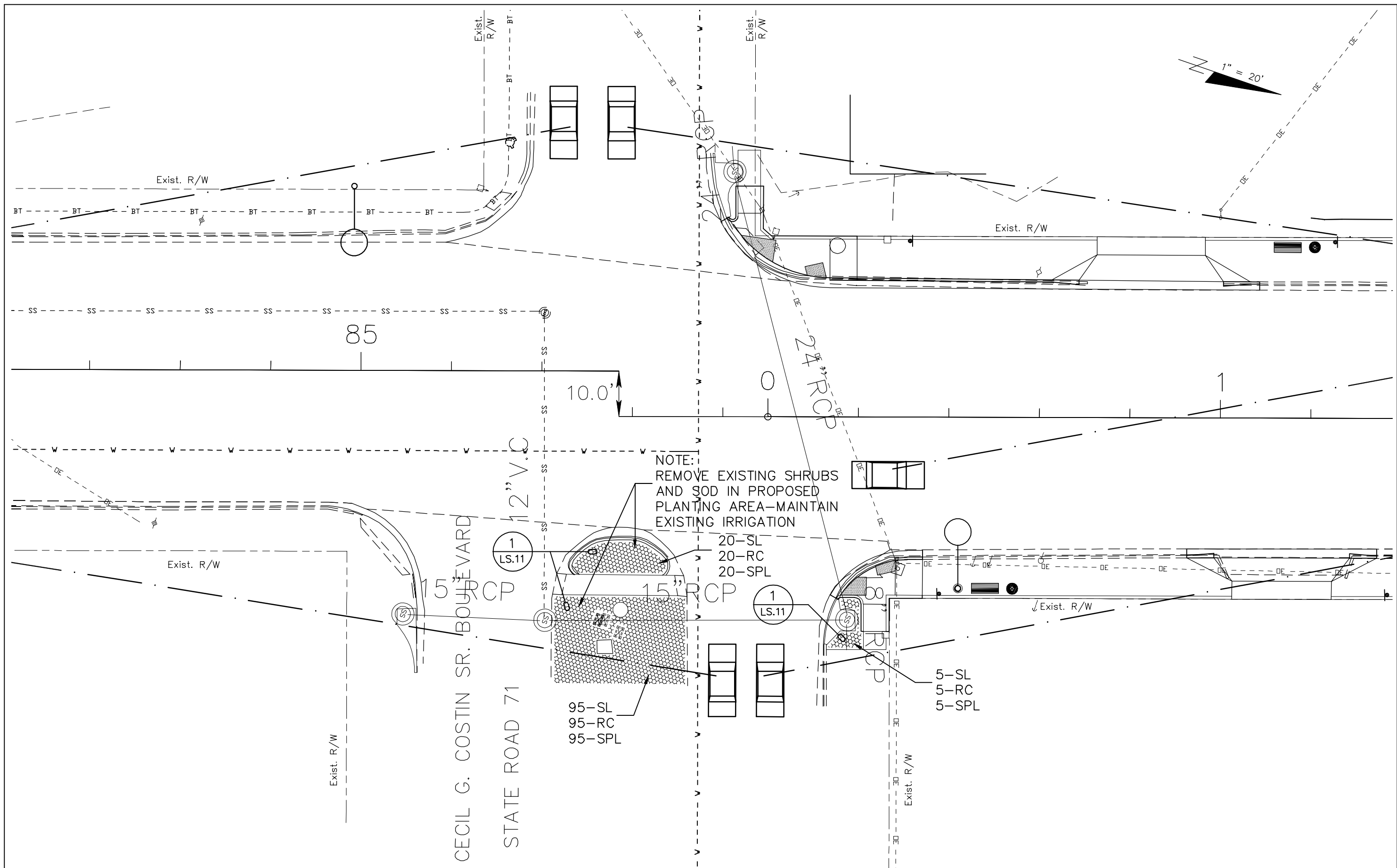

REVISIONS						JOSEPH C. PETRICH, R.L.A. R.L.A. LICENSE NUMBER 1173 GGI, LLC, dba GENESIS GROUP 9822 TAPESTRY PARK CIRCLE, SUITE 201 JACKSONVILLE, FL 32246 LANDSCAPE ARCHITECTURE LC26000202	CITY OF PORT ST. JOE, FLORIDA			LANDSCAPE PLAN	SHEET NO.
DATE	BY	DESCRIPTION	DATE	BY	DESCRIPTION		ROAD NO.	COUNTY	FINANCIAL PROJECT ID		LS.04
							30(U.S.98)	GULF	416533-6-58-05		

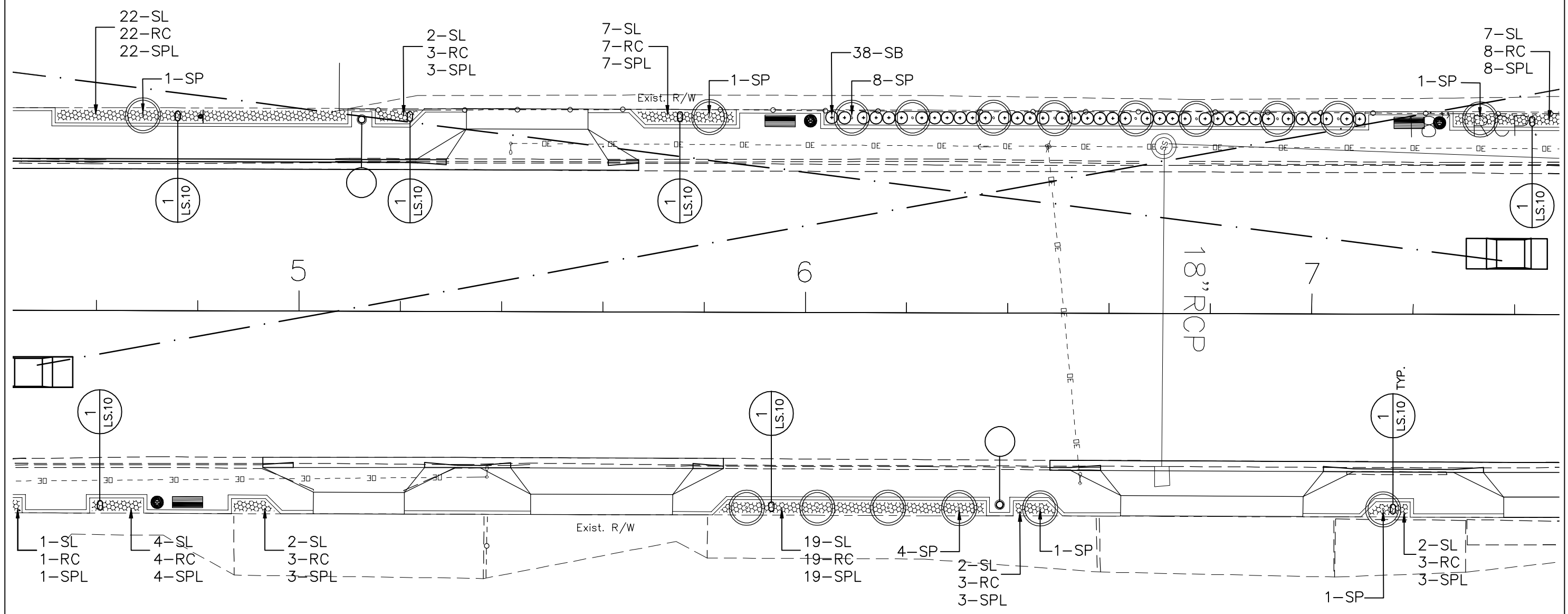
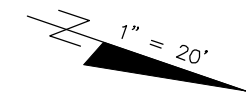

REVISIONS					
DATE	BY	DESCRIPTION	DATE	BY	DESCRIPTION

JOSEPH C. PETRICH, R.L.A.
 R.L.A. LICENSE NUMBER 1173
 GGI, LLC, dba GENESIS GROUP
 9822 TAPESTRY PARK CIRCLE, SUITE 201
 JACKSONVILLE, FL 32246
 LANDSCAPE ARCHITECTURE LC26000202

CITY OF PORT ST. JOE, FLORIDA		
ROAD NO.	COUNTY	FINANCIAL PROJECT ID
30(U.S.98)	GULF	416533-6-58-05

LANDSCAPE
PLAN

SHEET NO.
LS.06

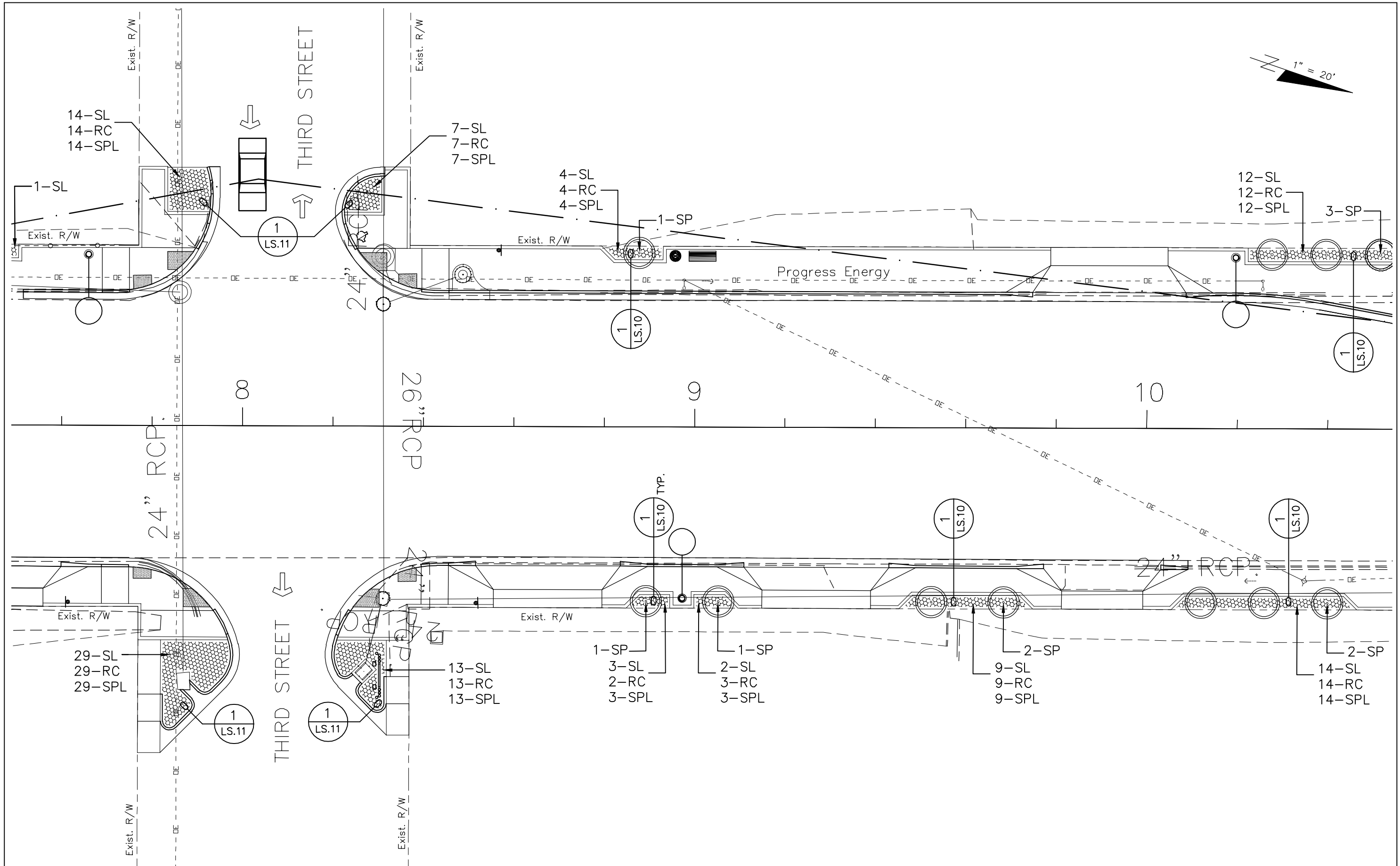
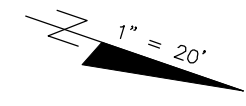

REVISIONS					
DATE	BY	DESCRIPTION	DATE	BY	DESCRIPTION

JOSEPH C. PETRICH, R.L.A.
 R.L.A. LICENSE NUMBER 1173
 GGI, LLC, dba GENESIS GROUP
 9822 TAPESTRY PARK CIRCLE, SUITE 201
 JACKSONVILLE, FL 32246
 LANDSCAPE ARCHITECTURE LC26000202

CITY OF PORT ST. JOE, FLORIDA		
ROAD NO.	COUNTY	FINANCIAL PROJECT ID
30(U.S.98)	GULF	416533-6-58-05

LANDSCAPE
PLAN

SHEET
NO.
LS.07

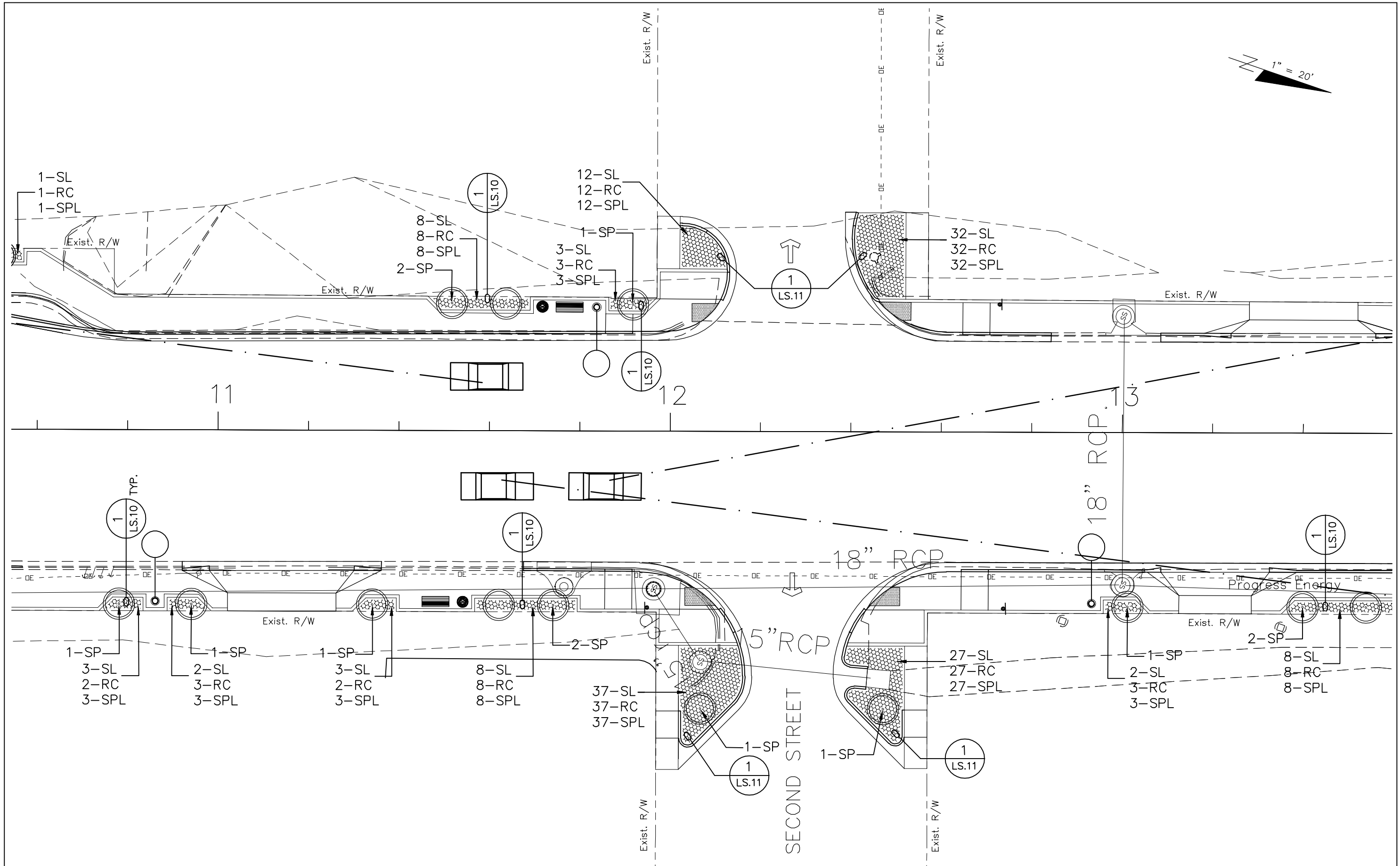
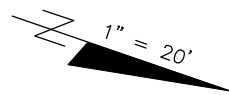

REVISIONS						JOSEPH C. PETRICH, R.L.A. R.L.A. LICENSE NUMBER 1173 GGI, LLC, dba GENESIS GROUP 9822 TAPESTRY PARK CIRCLE, SUITE 201 JACKSONVILLE, FL 32246 LANDSCAPE ARCHITECTURE LC26000202	CITY OF PORT ST. JOE, FLORIDA			LANDSCAPE PLAN	SHEET NO.
DATE	BY	DESCRIPTION	DATE	BY	DESCRIPTION		ROAD NO.	COUNTY	FINANCIAL PROJECT ID		LS.08
							30(U.S.98)	GULF	416533-6-58-05		

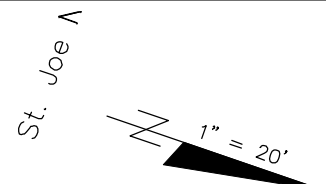
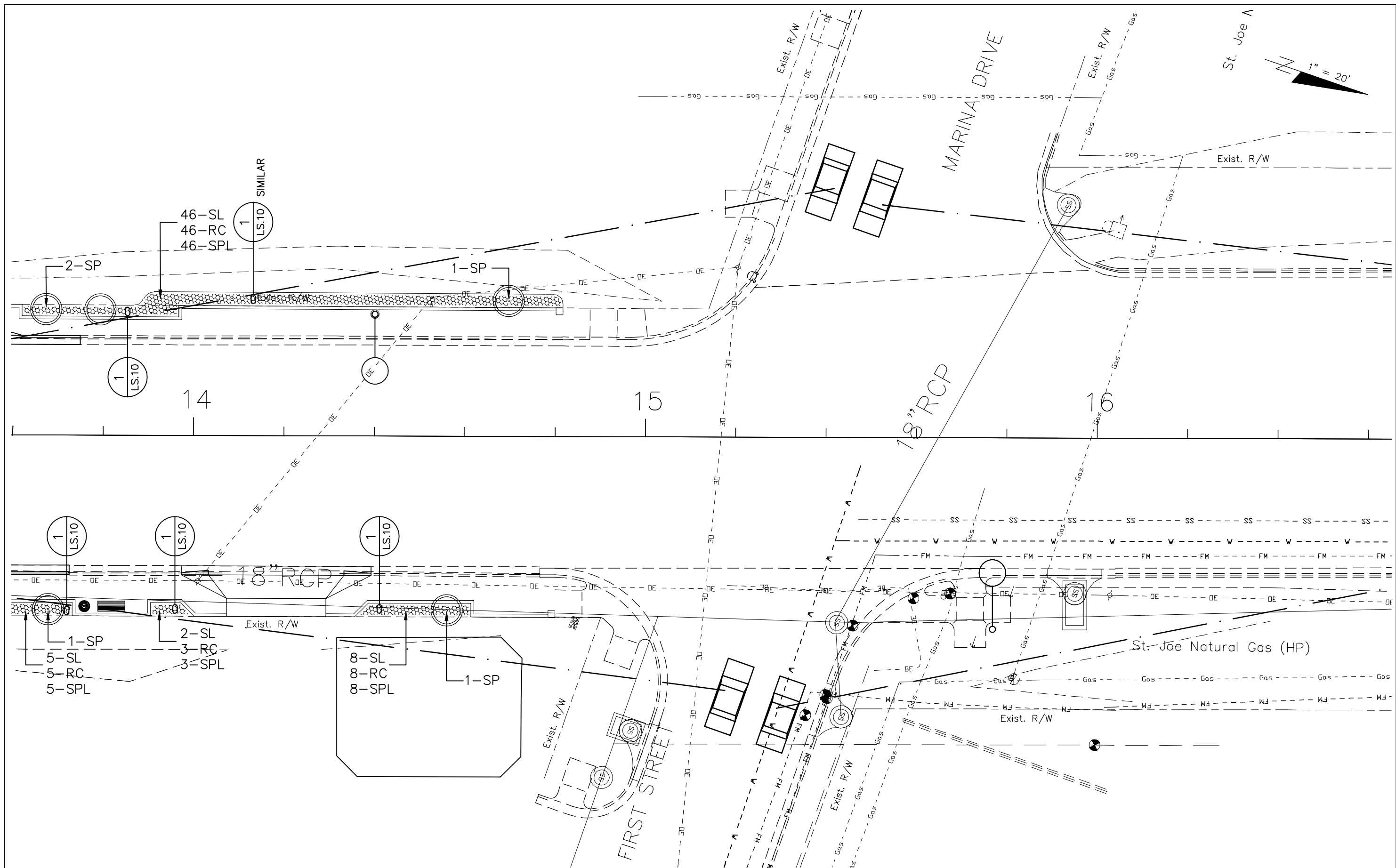

REVISIONS					
DATE	BY	DESCRIPTION	DATE	BY	DESCRIPTION

JOSEPH C. PETRICH, R.L.A.
 R.L.A. LICENSE NUMBER 1173
 GGI, LLC, dba GENESIS GROUP
 9822 TAPESTRY PARK CIRCLE, SUITE 201
 JACKSONVILLE, FL 32246
 LANDSCAPE ARCHITECTURE LC26000202

CITY OF PORT ST. JOE, FLORIDA		
ROAD NO.	COUNTY	FINANCIAL PROJECT ID
30(U.S.98)	GULF	416533-6-58-05

LANDSCAPE
PLAN

SHEET NO.
LS.09

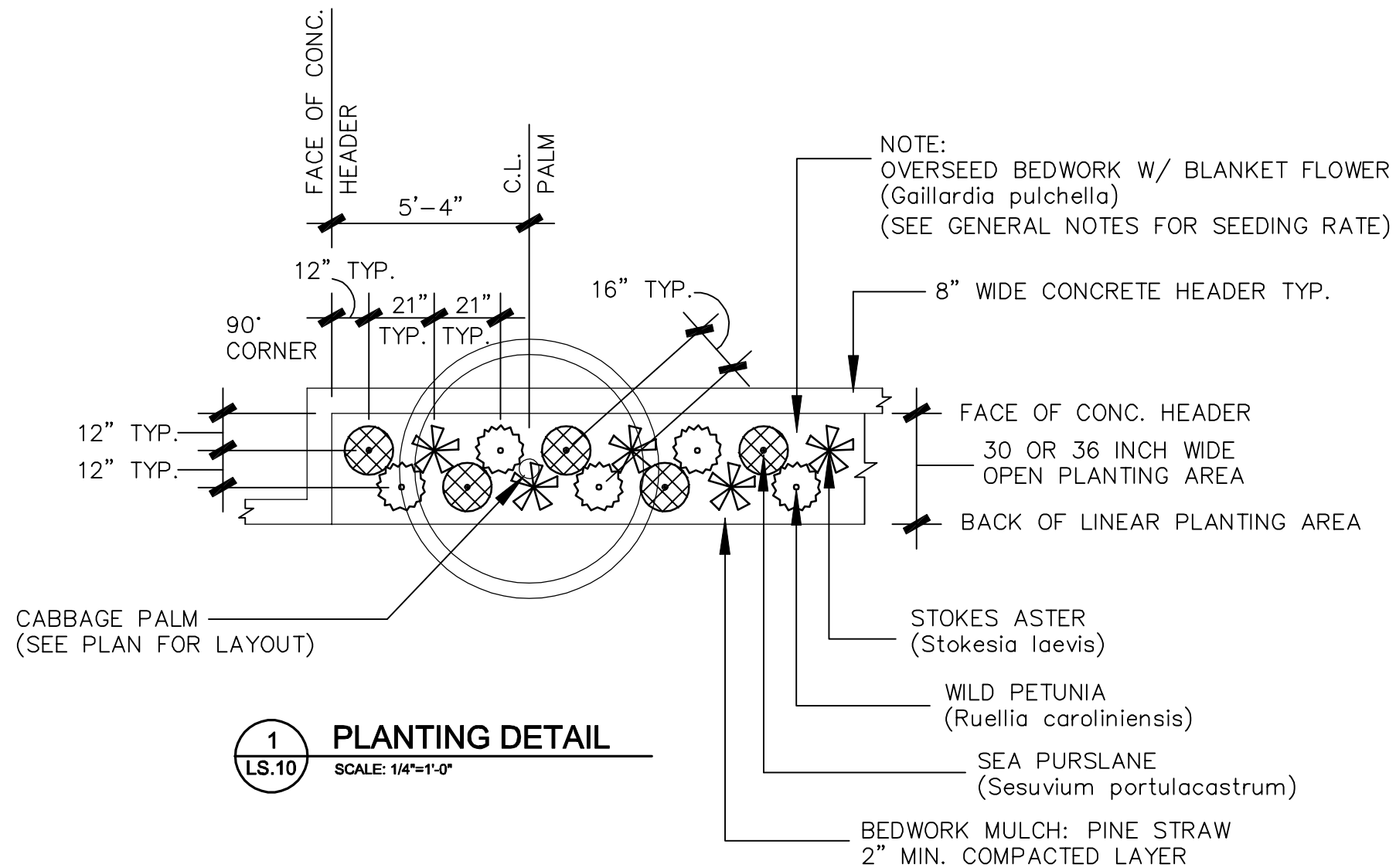

1 PLANTING DETAIL
 LS.10 SCALE: 1/4"=1'-0"

REVISIONS						JOSEPH C. PETRICH, R.L.A. R.L.A. LICENSE NUMBER 1173 GGI, LLC, dba GENESIS GROUP 9822 TAPESTRY PARK CIRCLE, SUITE 201 JACKSONVILLE, FL 32246 LANDSCAPE ARCHITECTURE LC26000202	CITY OF PORT ST. JOE, FLORIDA			LANDSCAPE DETAILS	SHEET NO.
DATE	BY	DESCRIPTION	DATE	BY	DESCRIPTION		ROAD NO.	COUNTY	FINANCIAL PROJECT ID		LS.10
							30(U.S.98)	GULF	416533-6-58-05		

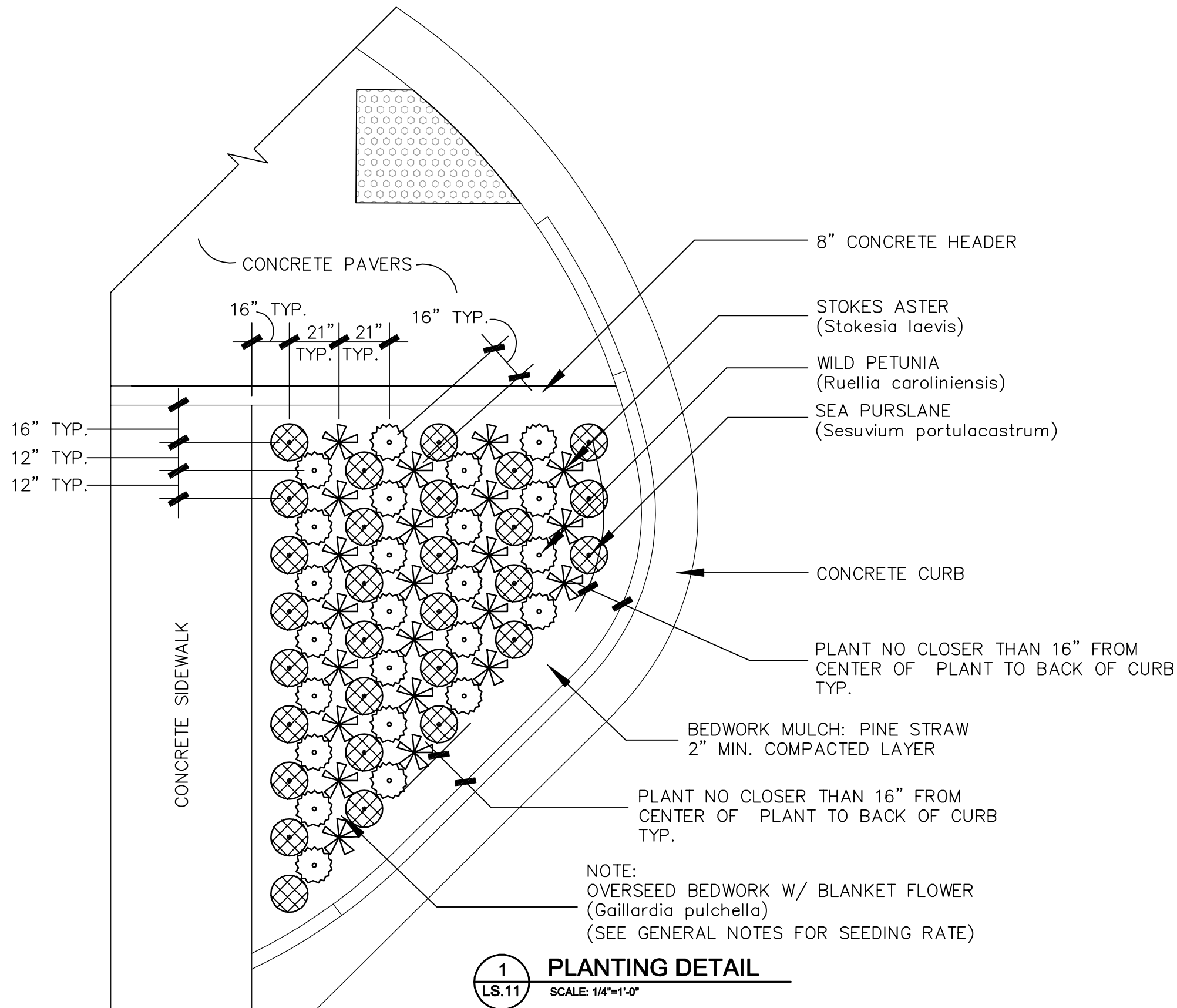

REVISIONS						JOSEPH C. PETRICH, R.L.A. R.L.A. LICENSE NUMBER 1173 GGI, LLC, dba GENESIS GROUP 9822 TAPESTRY PARK CIRCLE, SUITE 201 JACKSONVILLE, FL 32246 LANDSCAPE ARCHITECTURE LC26000202	CITY OF PORT ST. JOE, FLORIDA			LANDSCAPE DETAILS	SHEET NO.
DATE	BY	DESCRIPTION	DATE	BY	DESCRIPTION		ROAD NO.	COUNTY	FINANCIAL PROJECT ID		LS.11
							30(U.S.98)	GULF	416533-6-58-05		